

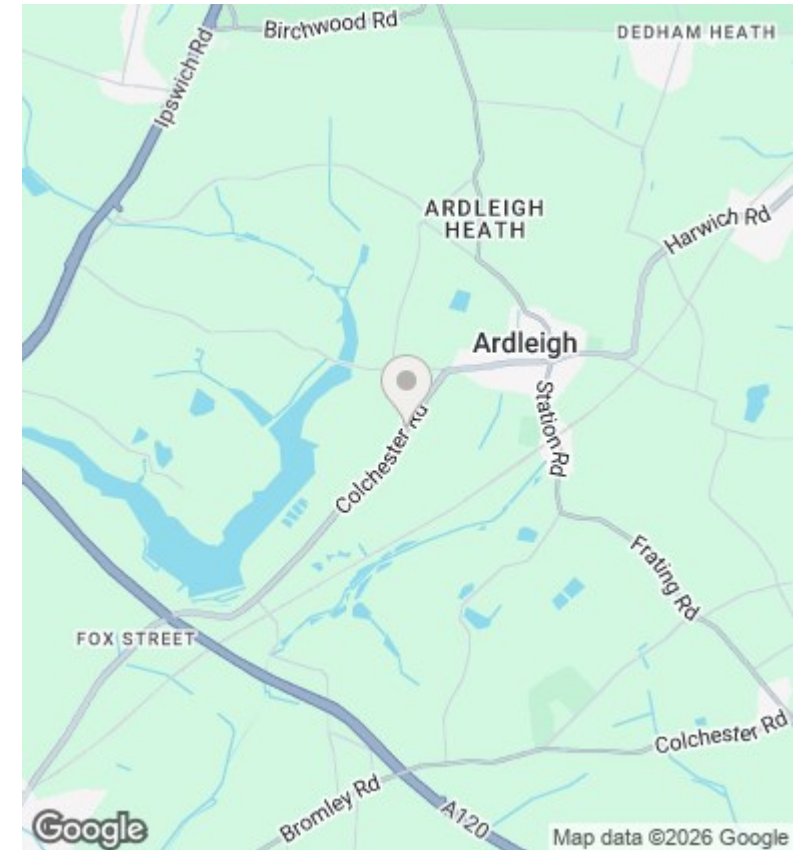

## Evergreen Colchester Road, Ardleigh, Colchester, CO7 7PB

£2,250 Per Month

- A Bespoke Three Bedroom Detached Bungalow
- French Doors With Panoramic Garden View
- Focal Open- Plan Kitchen/Living/Dining Room
- Contact Michaels Property Consultants
- Three Generously Sized Double Bedrooms
- Constructed By Highly Reputable Local Builders Alan Bender LTD
- Ample Off-Road Parking & Generously Sized Rear Garden
- Four Piece Family Bathroom Suite
- Rare Luxury Of Two En-Suite Shower Rooms
- Available April

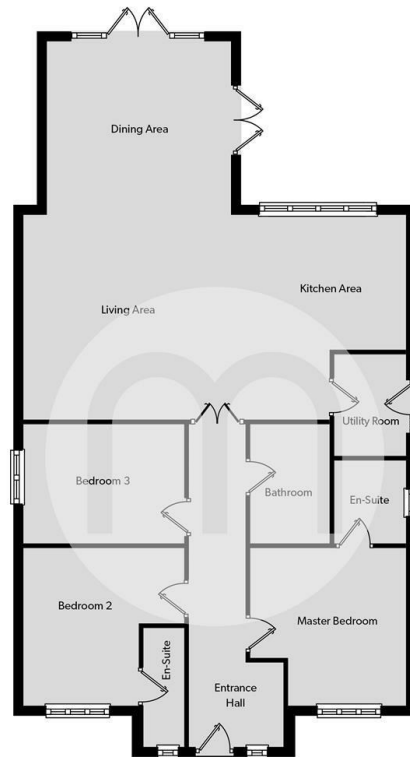

## Directions

## Viewings

Viewings by arrangement only. Call 01206 572555 to make an appointment.

## Council Tax Band

## EPC Rating:

Energy Efficiency Rating		
	Current	Potential
Very energy efficient - lower running costs		
(92 plus) <b>A</b>		
(81-91) <b>B</b>		
(69-80) <b>C</b>		
(55-68) <b>D</b>		
(39-54) <b>E</b>		
(21-38) <b>F</b>		
(1-20) <b>G</b>		
Not energy efficient - higher running costs		
<b>England &amp; Wales</b>	EU Directive 2002/91/EC	